



Bharati Vidyapeeth Deemed University
College of Architecture



Welcomes You

Presentation for
Collaboration with Design School of ASU
5th September 2022

1 Content

- Brief overview of Architecture College
- Masters in Sustainable Architecture
- Collaborations
- Research Areas
- Achievements

2 Overview

- 1st Institution in the country to offer **Masters Degree in Sustainable Architecture**
- **Pioneer** institute in starting **Pune Biennale**
- High rate of publications –
- **Initiated the Doctoral Program in 2022**
- **6** research scholars enrolled for **Doctoral Program**
- Qualified staff to handle B.Arch. & M.Arch Courses- **100% Postgraduate from diverse fields**
- **Conducted International** : Study Tour, Joint Workshops and Student Exchange Program
- **Recipient of IGBC Green Championship Award for the Institute : Bharati Vidyapeeth College of Architecture, Pune' was unanimously chosen as a winner of the 6th IGBC Green Champion Award under the category of 'Institute encouraging IGBC Accredited Professionals'.**
- **Conducted a National Digital Conference on Sustainability, Architecture, Planning and Technology during Covid**
- **40%** students progress from Undergraduate to Post graduate studies
- **60% students have become entrepreneurs**

3 Introduction

- From its **establishment in 1994**, the college has helped more than **1000** students to achieve their dream of becoming architects.
- Since the introduction of first **Masters Degree in Sustainable Architecture in 2006**, more than **200** postgraduates have found excellent work opportunities in the fields related **to built environment and sustainability**.

Academic Offerings :

Bachelor of Architecture :

Enrolments per year 80

Master of Architecture :

Enrolments per year 20

Doctoral Program:

Enrolments per year 6



- | | |
|---------------------------------|---|
| Curriculum Design & Development | <ul style="list-style-type: none">✓ Master of Architecture (Sustainable Architecture) adopted CBCS from Academic Year 2014-15✓ Bachelor of Architecture adopted CBCS from Academic Year 2015-16✓ Curriculum is based on Blooms Taxonomy which focuses on OBE |
| Academic Flexibility | <ul style="list-style-type: none">✓ Core and Elective options for B.Arch and M.Arch in CBCS pattern✓ Courses divided in teaching modules✓ Progressive assessment (IA)✓ Award of extra credits for co-curricular and extracurricular activities |
| Curriculum Enrichment | <ul style="list-style-type: none">✓ Interdisciplinary study offered through electives, self study and seminar. |
| Feedback System | <ul style="list-style-type: none">✓ Virtual education program and engagement with experts initiated✓ Capstone Project for final year students✓ Assignments related to real life projects and sites.✓ Innovative ways of teaching through music, drama, photography, film making |

Curriculum Design
& Development

- Architectural Design- I,II,III,IV,V
- Building Construction and Material-I,II,III,IV,V,VI
- Theory of Structures-I,II,III,IV,V,VI

Academic
Flexibility

- History of Architecture –I,II,III,IV
- Architecture Drawings and Graphics-I,II,III

Curriculum
Enrichment

- Building Services I,II,III,IV
- Basic Design-I,II
- Landscape Architecture I,II

Feedback
System

- Climatology, Landscape Architecture, Specifications, Working Drawing, Urban Planning, Research in Architecture, Interior Design, Elective ,Workshop

	Semester I	Semester II	Semester III	Semester IV
Environment	Sustainable Development	Green Building Assessment Certification	Advanced Simulation Modeling	Internship (40 DAYS)
Energy	Energy management and audit	Energy systems and Utilities	Clean Technologies	
Design	Sustainable Design Studio-I	Sustainable Design Studio-II	Sustainable Design Studio-III	Dissertation II
Resources	Energy Conservation (Thermal)	Energy Conservation II (Luminous)	Energy Conservation III (Acoustics & Aqueous)	
Research	Sustainable materials and technology	Research Design and Methods	Dissertation I	Self Study
Allied	Elective I	Elective II	Elective III	Seminar

7 List of Elective Choices

Core subjects	Allied	Open electives
Energy efficient lighting of interiors	Building Information Modeling	Swatchh Bharat
Urban Wetlands	Visual communication	Traditional knowledge systems related to conservation of resources
Zero energy development	Advanced HVAC systems	Humanities and social sciences
Façade design	Disaster Management	Community Services
Vernacular architecture	Digital Architecture	Writing and verbal skills

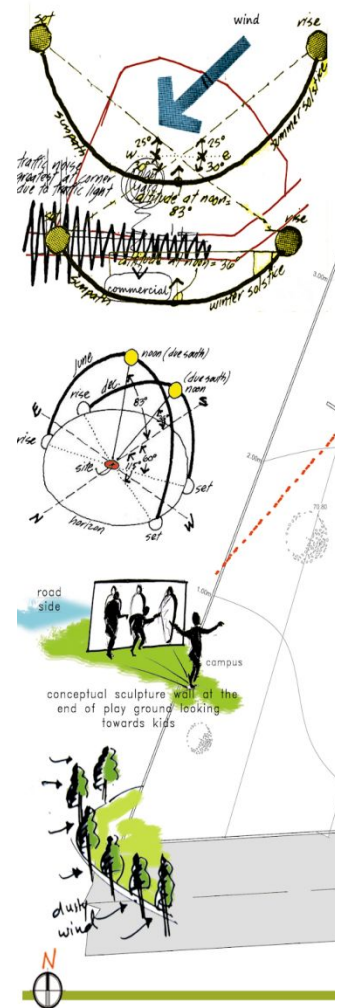

8 Teaching, learning and Evaluation

Student Enrollment ✓
and Profile

Organizing teaching, learning and evaluation schedules

- Academic calendar and teaching schedules displayed
- Attendance and progressive assessment displayed
- Periodic juries for assessment of work
- Site visits and project works

Catering to
Student Diversity

Teaching-Learning
Process

Teacher Quality

Evaluation Process
and Reforms

Student
Performance and
Learning Outcomes



9 Teaching, learning and Evaluation

Student Enrollment and Profile

Catering to Student Diversity

Teaching-Learning Process

Teacher Quality

Evaluation Process and Reforms

Student Performance and Learning Outcomes

- Hands on workshop for students
- Faculty Development Programs for enhancing Teacher Quality
- Assessment of students performance based on Internal Assessments and University Exams

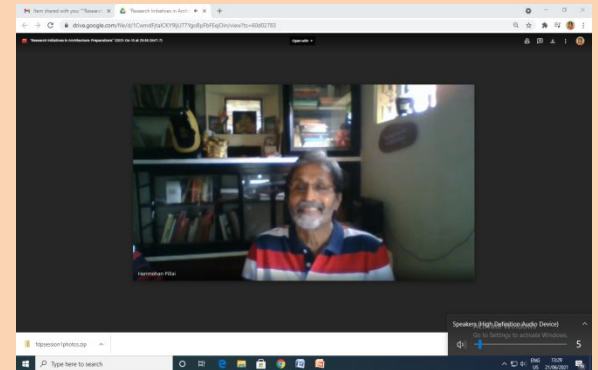
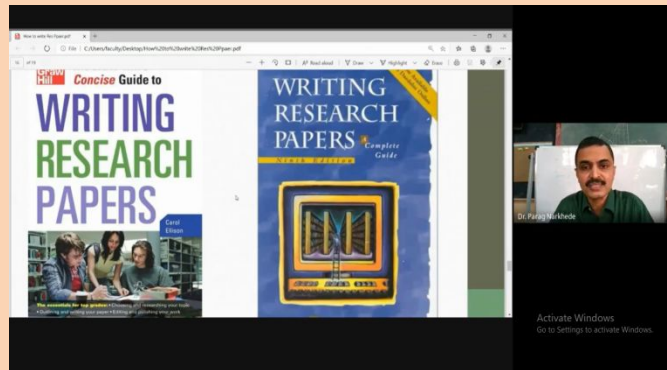

10 Design Projects Undergraduate Program

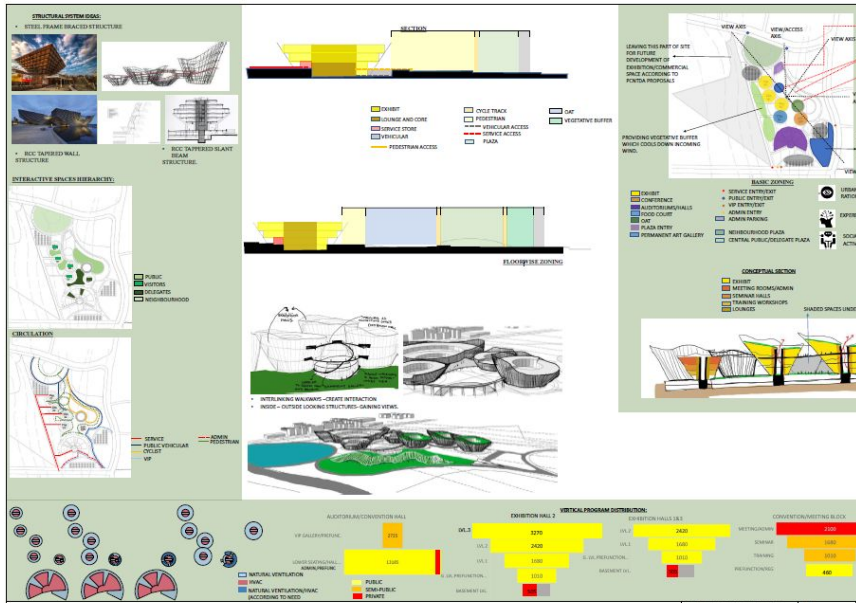

LANDSCAPE LAYOUT

LANDSCAPE PLAN:



CONCEPT:

The concept here is to create a landscape pattern that would not only respect the presence of the world class architecture but also the architectural character of the building.
 Given the site topography, soil and climate, it is major concern for the neighboring context. This has been achieved by a complete ecosystem help in the existing local soil and vegetation, etc. aspects.

HERBARIUM:

Symbol	Detailed description
1	Name: Heeri Tree "Acacia indica" Type: Shrub growing evergreen tree Height: 1.5-2M Trunk dia: 45-47 CM
2	Name: Heeri Tree "Acacia indica" Type: Shrub growing evergreen tree Height: 1.5-2M Trunk dia: 45-47 CM
3	Name: Anika Tree "Palafoxia longifolia" Type: Ornamental tree Height: 1.5-2M Trunk dia: 36-38 CM
4	Name: Anika Tree "Heeri Tree" Type: Ornamental tree Height: 1.5-2M Trunk dia: 11-12 CM
5	Name: Anika Tree "Heeri Tree" Type: Ornamental tree Height: 1.5-2M Trunk dia: 11-12 CM
6	Name: Anika Tree "Heeri Tree" Type: Ornamental tree Height: 1.5-2M Trunk dia: 11-12 CM
7	Name: Anika Tree "Heeri Tree" Type: Ornamental tree Height: 1.5-2M Trunk dia: 11-12 CM
8	Name: Anika Tree "Heeri Tree" Type: Ornamental tree Height: 1.5-2M Trunk dia: 11-12 CM
9	Name: Anika Tree "Heeri Tree" Type: Ornamental tree Height: 1.5-2M Trunk dia: 11-12 CM
10	Name: Anika Tree "Heeri Tree" Type: Ornamental tree Height: 1.5-2M Trunk dia: 11-12 CM
11	Name: Anika Tree "Heeri Tree" Type: Ornamental tree Height: 1.5-2M Trunk dia: 11-12 CM
12	Name: Anika Tree "Heeri Tree" Type: Ornamental tree Height: 1.5-2M Trunk dia: 11-12 CM

LANDSCAPE LAYOUT

SECTION X-X':

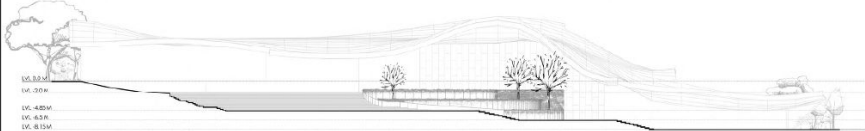

BLOW-UP PLAN FOR LANDSCAPE AREA:

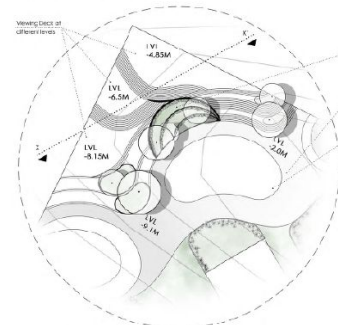

CONCEPT SKETCHES:

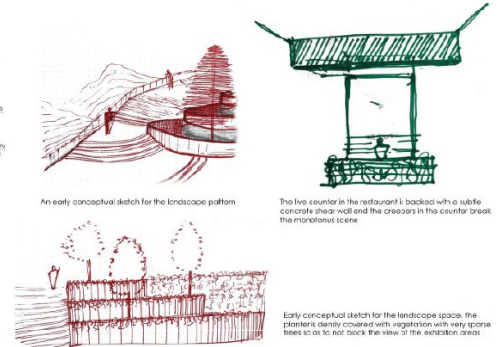

11 Design Projects Masters Program

GREEN IT PARK @ HYDERABAD

Strategies for a Green IT campus...

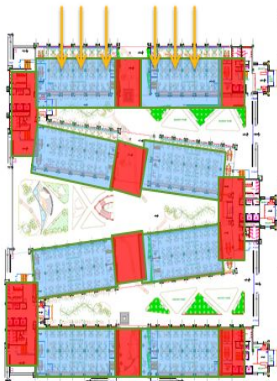

Orientation :

- Maximum exposure to north and south for maximum day light.
- Buffer zones on east and west.
- Minimum heat gain inside the office space.
- Mutual shading obtained by variation in height.
- 35m X 16m of office space for maximum day lighting.



GREEN IT PARK @ HYDERABAD

>Through Day Lighting...

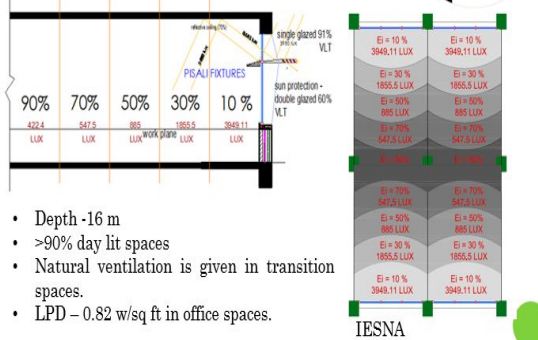
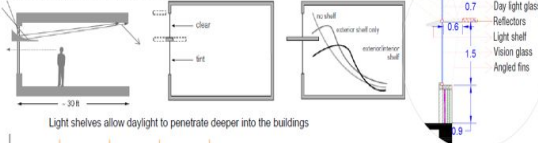

- Depth -16 m
- >90% day lit spaces
- Natural ventilation is given in transition spaces.
- LPD - 0.82 w/sq ft in office spaces.

IESNA



12 Collaborations

Faculty Exchange
and Development

Promotion of
Interdisciplinary
Research

Joint Studios

Student Exchange
Programs

Facilitate
Researchers of
Eminence

- The University of Rome “La Sapienza”, Italy
- King Mongkut’s University of Technology Thonburi, Thailand
- School of Urban and Regional Planning, Queen’s University, Kingston, Canada
- Saint Petersburg National Research University Of Information Technologies, Mechanics and Optics (ITMO), Russia



Dr. Anil Agarwal and his students from Queens University, Canada visited BVPCOA in 2015 for a month-long studio in Pune

Dr. Kiran Shinde invited to Queens University, Canada, during 24th to 29th March 2014.



As part the MOU between Bharati Vidyapeeth Deemed University, Pune, India and University of Sunshine Coast: **Artist Kevin Todd** gave a presentation on 'Arts Practice' on 3rd July, 2012 Presentation followed by workshop on “**Colour in Culture**” for Second year B. Arch. students of BVDU College of architecture

13 Collaborations

Faculty Exchange and Development

Promotion of Interdisciplinary Research

Joint Studios

Student Exchange Programs

Facilitate Researchers of Eminence

- The College has organized **joint studios national and international institutions** (Sadar Bazar Study Report)
- Exchanging faculty for various subjects and project-specific interactions
- Encouraging students to work **on the field**
- **Arranging visits to established laboratories** of repute at other departments and Universities to expose the students with the latest technologies

2014-15
Bharati Vidyapeeth Deemed University
College of Architecture, Pune-43

International Collaboration with Queen's University, Canada

Urban planning studio on 'Heritage Management & Promotion Strategy for Pune's Sadar Bazaar'

December 5th to 17th, 2014

Coordinated by: Dr. Kiran Shinde, Dr. Ajay Agarwal, Prof. Archana Gaikwad

As a part of collaboration between Queen's University, Canada and Bharati Vidyapeeth Deemed University, India; urban planning studio focusing on '**heritage management**' for Sadar Bazaar area of Pune was conducted during period 5th-17th December 2014 by Queen's students. Six students of college of architecture, BVDU participated in this studio.

On 5th December student's of Queen's university presented case studies, followed by workshop to decide the strategies. Faculty of college of architecture, BVDU, experts and probable stakeholders participated in this workshop held at BVDUCOA, Pune.

Next two week's field work was done. Final presentation was arranged at Sumant Moolgaokar Auditorium, Senapati Bapat road open to all citizens on 17th December 2014.



Source: Queens University, Queens Gazette Under MOU:
School of Urban and Regional Planning, Queen's University at Kingston, Canada (19 Oct 2012, for initial period of 5 years)

Queens University

NEWS MEDIA CENTRE UNIVE

Queen's gazette

Thursday, September 29, 2016

India project a valuable experience for SURP students

Wednesday January 7, 2015
By Andrew Carroll, Gazette Editor

Share Tweet Email Print



School of Urban and Regional Planning students attend a workshop at Bharati Vidyapeeth Deemed University (BVDU) after arriving in Pune, India. (Supplied photo)

14 Collaborations

Faculty Exchange and Development

Promotion of Interdisciplinary Research

Joint Studios

Student Exchange Programs

Facilitate Researchers of Eminence

As part the MOU between Bharati Vidyapeeth Deemed University, Pune, India and KMUTT, Thailand : **Study visit by students of masters department to Thailand, “Exploring Bangkok through an Architect’s Eyes”**



Masters Students visit KMUTT, Thailand



16 Collaborations

Faculty Exchange
and Development

Promotion of
Interdisciplinary
Research

Joint Studios

Student Exchange
Programs

Facilitate
Researchers of
Eminence

International Collaboration with Queen's University, Canada
Urban planning studio on 'Heritage Management & Promotion Strategy for Pune's Sadar Bazaar'
December 5th to 17th, 2014



Exchanging faculty for various
subjects and project-specific
interactions



17 Collaborations

Faculty Exchange and Development

Promotion of Interdisciplinary Research

Joint Studios

Student Exchange Programs

Facilitate Researchers of Eminence

Student Exchange / exposure

- As part the MOU between Bharati Vidyapeeth Deemed University, Pune, India and University of Sunshine coast: **Manasi Saxena and Juliana Job studied design for a semester in USC on a scholarship**

Exchange builds an artistic link with India

Study Abroad program promotes cross-cultural relationships

A WELL-STRUCTURED teaching system, surf beaches and their first barbecue were listed as highlights by three Indian nationals who studied on scholarships at USC last semester.

Architecture students Juliana Job, 21, and Manasi Saxena, 23, from Bharati Vidyapeeth Deemed University, studied Design subjects at USC through the University's Study Abroad Program.

They also received the Queensland Government's \$10,000 Indian Friendship Scholarship, which helped pay for accommodation and other living expenses.



▲ Manasi Saxena, Shrawan Muralidhar and Juliana Job enjoy their time at USC.

Masters student Shrawan Muralidhar, 25, who is specialising in visual communication at the Indian Institute of Technology, Bombay, also studied at USC last semester on a \$10,000 USC International Scholarship.

Senior Lecturer in Art and Design Kevin

Todd said the cross-cultural relationships between USC and institutions in India were important and enriching for those involved.

Mr Todd will travel to Bharati Vidyapeeth University this semester to conduct lectures and run workshops in Art and Design.



18 Collaborations

Faculty Exchange and Development

Promotion of Interdisciplinary Research

Joint Studios

Student Exchange Programs

Facilitate Researchers of Eminence

Collaboration with other agencies impacted the visibility, identity and diversity of activities on campus

Resilience – Earthquake and disaster preparedness symposium with PMC and NIDM



Academically: A number of workshops and lecture series were organized in collaboration and also from the funds received. A number of evacuation and fire emergency drills were also conducted giving exposure to real life emergency situations in the buildings with fire, to the students.

Financially: National Institute of Disaster Management: @ 2.9 lakhs; Pune Municipal Corporation: @ Rs. 1.85 lakhs.

19 Collaborations

Faculty Exchange
and Development

Promotion of
Interdisciplinary
Research

Joint Studios

Student Exchange
Programs

Facilitate
Researchers of
Eminence

Collaboration with other agencies impacted the visibility,
identity and diversity of activities on campus

- National

- ISLE
- ASSOCHAM
- IGBC
- TERI
- IISC
- CEPT
- svagriha
- ENS
- ECBC

Training workshops for
students and staff
organized at the
Institute in collaboration
with ECBC,GRIHA



20 Research, Consultancy, and Extension

Promotion of
Research

Resource
Mobilization

Publications &
Awards

Consultancy

Extension Activities
and ISR

Research Areas of Faculty Members:

Sustainability : social, economic, environmental

Nano materials for Energy Conservation in building envelope

Urban planning and design

Urban and city planning Issues

Disaster Management

Historical development of Indian Architecture and Planning

Humanities, Culture, traditional systems

Natural ventilation potential and Indoor air quality in tall buildings

Urban heat island effect

Rural Development

21 Research, Consultancy, and Extension

Promotion of
Research

Resource
Mobilization

Publications &
Awards

Consultancy

Extension Activities
and ISR



Center for inclusive design and research

OUR VISION

A WORLD WITHOUT BARRIERS

OUR MISSION –

**INCLUSION AND EMPOWERMENT OF
MARGINALISED SECTIONS OF THE
SOCIETY INCLUDING PERSONS WITH
DISABILITIES BY LEVERAGING THE
POWER OF DESIGN.**

PRINCIPAL ACTIVITIES

- UNIVERSAL DESIGN EDUCATION AND CONSULTATION
- ACCESS AUDITS AND CERTIFICATION
- TECHNICAL TRAINING ON ACCESSIBILITY
- ACCESSIBILITY TRAINING FOR PWDs
- INCLUSIVE EDUCATION TRAINING
- RESEARCH AND POLICY STAKEHOLDER ENGAGEMENT
- SENSITIZATION AND AWARENESS CAMPAIGNS



UNITED NATIONS , VIENNA



ACTION AREAS -

RESEARCH

CONSULTANCY

TRAINING

AWARENESS

POLICY

ADVOCACY

22 Research, Consultancy, and Extension

Promotion of Research

Resource Mobilization

Publications & Awards

Consultancy

Extension Activities and ISR

✓ Extension activities

Events are regularly conducted as part of Institutional Social Responsibility to engage with local communities

- **Pune Biennale 2013: Hills: Tekadi**
Aalekhan Studio – Mapping the hills of Pune; participating institutes – BVPCOA, PVPCOA, BKPS, ACOA and BNCA (11-21 Jan 2013)



Call us: 020-2437-7809
Visit us: www.punebiennale.org
Write to us: mohor.punebiennale@gmail.com

INTRODUCTION
Hilltop houses built in unorganized fashion, the Ferguson College, B.M.C. and Sankarshi College. A small mountain-topside school and a few other structures. It was in 1960s till 80s on top. Many groups like green hills initiative and others have planted trees and re-landscaped.

HANUMAN TEKDI

TEKDI DO VIEW ADD

PEOPLE'S INITIATIVE

ECOLOGY

NEWS AND VIEWS

The green drive

Citizens tackle threat to ecology, and win

Related to: BHARATI VIDYAPEETH COLLEGE OF ARCHITECTURE
Tekdi Aalekhan Studio - Mapping the hills of Pune
Participating institutes: BVPCOA, PVPCOA, BKPS, ACOA & BNCA
Sponsored by: Chem Collection
Dispersed and authored by: PVP COLLEGE OF ARCHITECTURE

23 Research, Consultancy, and Extension

Promotion of
Research

Resource
Mobilization

Publications &
Awards

Consultancy

Extension Activities
and ISR

✓ Extension activities



Bamboo installation created in a public space at Sambhaji Park by students during Pune Biennale 2017



Interacting with the PMC commissioner, Mr. Kunal Kumar, Dr. Kiran Shinde at installation of amphitheater by an artist from ITALY Pune Biennale 2017

24 Research, Consultancy, and Extension

Promotion of
Research

Resource
Mobilization

Publications &
Awards

Consultancy

Extension Activities
and ISR

✓ Extension activities



Sculptures created out of vehicle metal junk in collaboration with PMC
Students get chance to work with national , international artists

25 Research, Consultancy, and Extension

Promotion of Research

Resource Mobilization

Publications & Awards

Consultancy

Extension Activities and ISR

✓ University-neighborhood network and student engagement

Programs were designed to promote student engagement for Community development. The outcomes were presented to the respective community members, municipal authorities and invited experts.

- **Pathways to Heritage Conservation** (Protection and Management Strategy for Pune's Sadar Bazaar) in association with Janwani and Queens University Canada
- **Solid waste management for Ward No. 73 and 74 Pune Municipal Corporation**

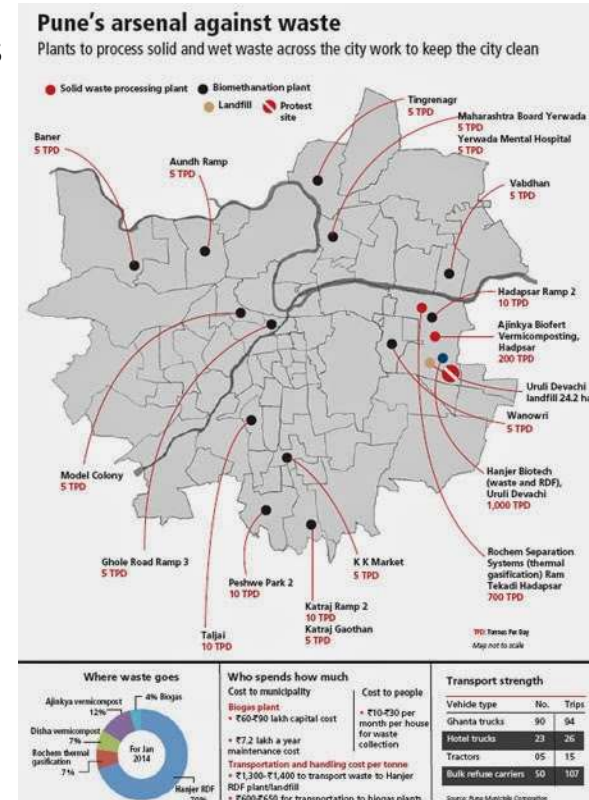

Zero Garbage Pune

WHAT IS THE MEANING OF 'ZERO GARBAGE'?

- ELIMINATING NEED FOR LANDFILLS** by reusing organic waste through biogas, composting and other technology and recycling plastic, paper, glass, metal, etc.
- ADDING VALUE TO WASTE** through use of innovative technologies to reuse organic waste and enhancing recycling through segregation and doorstep collection.
- CREATING A PARADIGM SHIFT** from garbage as disposal to garbage as a renewable resource by changing attitudes about the value and potential of trash.

WHO DOES IT HELP? ZERO GARBAGE MODEL HAS WIDE-RANGING BENEFITS

RESIDENTS

- Cleaner streets and neighborhoods.
- Improved quality of life by reducing health risks such as dengue fever and malaria, associated with garbage piles.
- Doorstep collection service of low cost.

WASTE PICKERS

- Improved quality of life with integration into doorstep collection to eliminate need to climb in community waste bins.
- Better health because of new conditions.
- Higher, more stable income.

GOVERNMENT

- Reduced transportation and landfill maintenance costs.
- Citizens forced to take responsibility for waste generation.
- Cleaner, more appealing city.

PHASE 1 WARDS

Waste Karve Nagar, Kothrud, Aundh, Ghole Road, Dhole Patil, Sangamwadi, Nagar Road, Kasaba Yesham, Tikar Road, Sahakarwadi, Bhavani Path, Hadapsar, Bibewadi, Dhankwadi (a), Dhankwadi (b)

Contact: Dr. Kabali Chitale, Senior Medical Officer for PMC, at 989931364, at Sahar Badaajar, Deputy Manager for Janwani, at 9970039394.

26 Research, Consultancy, and Extension

Promotion of
Research

Resource
Mobilization

Publications &
Awards

Consultancy

Extension Activities
and ISR

✓ Consultancy

Project Name:

Preparing **model Gram Panchayat Spatial Development Plan** for two pilot villages namely Rajuri and Belhe of junnar taluka of Pune district, Maharashtra.

Brief of the Project:

The **Ministry of Panchayati Raj** had assigned the task of preparing model GPSDP for two pilot villages to Bharati Vidyapeeth Deemed University's, College of Architecture, Pune.

Villages were shortlisted by the Ministry, and BVDU-COA, Pune; by conducting **data analysis of about 15 villages** in ten districts in western Maharashtra based on a set of prescribed criteria.



Achievements



'Bharati Vidyapeeth College of Architecture, Pune' was unanimously chosen as a winner of the 6th IGBC Green Champion Award under the category of 'Institute encouraging IGBC Accredited Professionals'.



Alumni Ketaki Rairikar – Exemplary Performance Award at the GRIHA Summit



Alumni Rahul Shrikhande – Exemplary Performance Award at the GRIHA Summit

THANK YOU